

Infinite possibilities - through...

- **Creative innovation**
- **Quality control**
- **Dedication to reliability**

Turns your visions into realities!



PRODUCT CATALOGUE

Exhaust Division

BAOLONG Shanghai Baolong Automotive Corporation

- Exhaust Tips
- Resonators
- Flexible Tubes
- Mufflers
- Direct-Fit Exhaust Systems
- Accessories

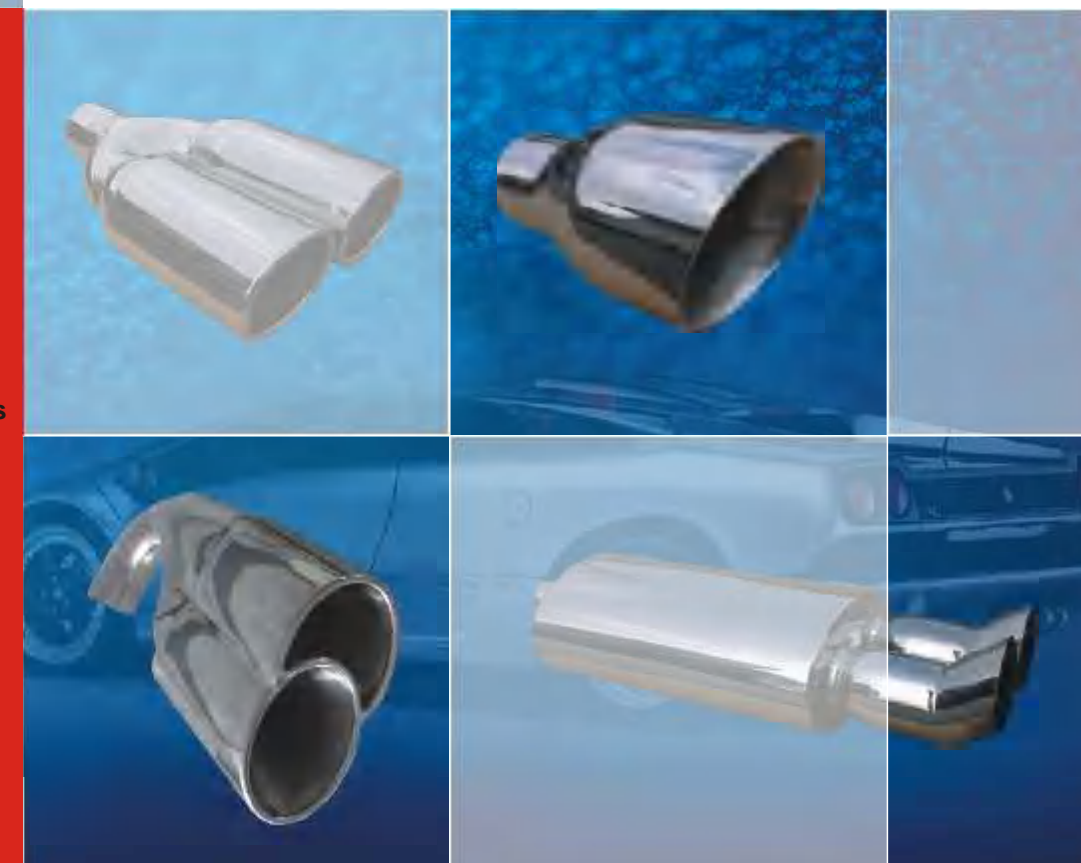

71, Maosheng Road, Dongjing, Songjiang, Shanghai 201619, China
Tel: +86-21-57690000 Fax: +86-21-57690035
E-mail: sbic@chinabaolong.net
www.baolong.biz

2010



Shanghai Baolong Automotive Corporation was founded in 1997, now grows to a leading player in the stainless steel exhaust system and tire valve business all over the world.

Our main products include: exhaust systems & components, tire valve & wheel service products, tire pressure monitoring system and mini digital air compressor, etc.

Our products have been exported to more than 60 countries, also successfully supplied to most of the car makers, such as: General Motor, Ford, VW, Peugeot, Nissan, Benz, BMW, etc, with the quality evidenced by various certifications: ISO/TS 16949, and ISO14001, etc.

With the decades of experience in the exhaust system business, competitive cost, thousands of available design, satisfying delivery and accurate claim solutions are ensured.



Baolong Anhui Auto-parts Co., Ltd, 100% owned by SBAC, is located in Ningguo city, Anhui Province, with 181,266 m² floor area. With the decade of experience, we now have become a leading manufacturer of exhaust tips and performance systems in China, and one of the largest OE suppliers in the world.



8 workshops, 581 equipments and hundreds of experienced staff are our guarantee to the OE quality and challenging delivery, as well as to the thousands of available designs.



Strong R & D team
Design part independently / as per requirement
Self design and make the tooling / jig / gauge
Continuously researching & improving



In house tests available

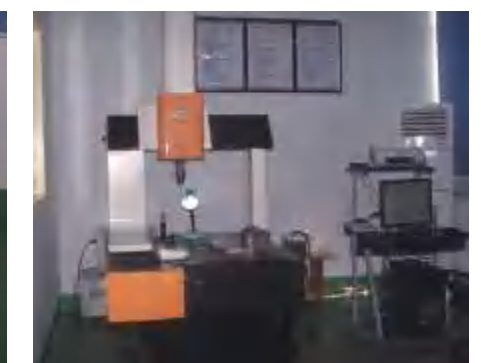

Our available material, but not limited to: 304, 409, 439, aluminized steel
Our available finish treatment, but not limited to: grinding, polish, mirror polish, Nickel&Chome plating, Chrome Flash, painting.

CAYENNE



FORD MONDEO



CHEVROLET CORVETTE



PEUGEOT 207



MINI COOPER



CITROEN C5



GM BUICK ENCLAVE



Table of Content

<i>Round Tips</i>	1-8
<i>Oval Tips</i>	9-15
<i>Square Tips</i>	16
<i>Homocentric Tips</i>	17
<i>Dual Outlet Tips</i>	18-21
<i>Special Tips</i>	22-23
<i>Resonators</i>	24
<i>Flexible Tubes</i>	25-26
<i>Mufflers</i>	27-32
<i>Direct-Fit Exhaust Systems</i>	33-34
<i>Accessories</i>	35

304 Polished Stainless Steel

Round Tube -> ID=OD -> Single Layer -> Straight Cut

Order No.	Inlet Dia.	Outlet Dia.	Overall Length
31111103	60	60	350



Part No.: P001

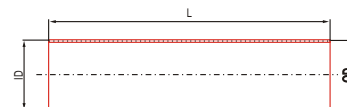

Round Tube -> ID=OD -> Single Layer -> Angle Cut

Order No.	Inlet Dia.	Outlet Dia.	Overall Length
31111201	57.5	57.5	153



Part No.: P002

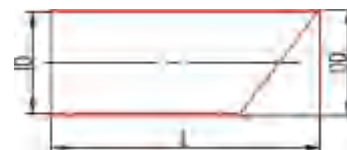

Round Tube -> ID=OD -> Single Layer -> Rolled, Straight Cut

Order No.	Inlet Dia.	Outlet Dia.	Overall Length
31111303	80	80	330



Part No.: P003



Round Tube -> ID=OD -> Single Layer -> Rolled, Angle Cut

Order No.	Inlet Dia.	Outlet Dia.	Overall Length
31111404	80	80	300
31111407	127	127	336



Part No.: P004



Round Tube -> ID=OD -> Single Layer -> DTM

Order No.	Inlet Dia.	Outlet Dia.	Overall Length
31111504	89	89	340



Part No.: P005



Round Tube -> ID=OD -> Double Layer, Silenced -> Rolled, Straight Cut

Order No.	Inlet Dia.	Outlet Dia.	Overall Length
31113301	82.5	82.5	330



Part No.: P021



304 Polished Stainless Steel

Round Tube -> ID=OD -> Double Layer, Silenced -> Rolled, Angle Cut

Order No.	Inlet Dia.	Outlet Dia.	Overall Length
31113401	76	76	330



Part No.: P022



Round Tube -> ID<OD -> Single Layer -> Straight Cut

Order No.	Inlet Dia.	Outlet Dia.	Overall Length
31121101	58	102	560
31121102	58	102	457
31121103	58	102	305
31121105	58	89	457
31121106	58	89	305
31121107	58	76	560
31121108	58	76	457
31121109	58	76	305
31121110	64	89	457
31121111	76	89	457
31121112	64	89	560
31121113	76	89	560



Part No.: P028

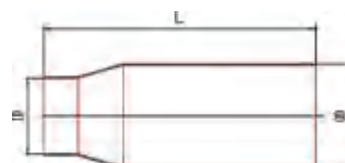

Round Tube -> ID<OD -> Single Layer-> Angle Cut

Order No.	Inlet Dia.	Outlet Dia.	Overall Length
31121201	58	102	178
31121202	58	102	560
31121203	58	102	457
31121204	58	102	305
31121205	58	89	560
31121206	58	89	457
31121207	58	89	305
31121208	58	76	560
31121209	58	76	457
31121210	58	76	305
31121211	64	89	254
31121212	64	76	457
31121213	64	89	457
31121214	76	89	457
31121215	64	89	560
31121216	76	89	560
31121217	89	102	305
31121219	64	76	305
31121220	64	102	457



Part No.: P029



Round Tube -> ID<OD -> Single Layer -> Rolled, Straight Cut

Order No.	Inlet Dia.	Outlet Dia.	Overall Length
31121311	58	89	184
31121312	54	89	184



Part No.: P030

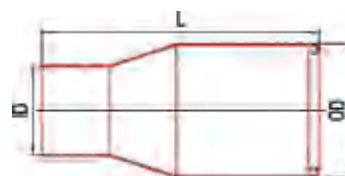

304 Polished Stainless Steel

Round Tube -> ID≠OD -> Single Layer -> Rolled, Straight Cut

Order No.	Inlet Dia.	Outlet Dia.	Overall Length
31121301	58	63	254



Part No.: P030-2

Round Tube -> ID<OD -> Single Layer -> Rolled, Straight Cut

Order No.	Inlet Dia.	Outlet Dia.	Overall Length
31121331	58	76	305
31121332	58	89	305
31121333	58	102	305
31121334	58	76	457
31121335	58	89	457
31121336	58	102	457
31121337	58	76	560
31121338	58	89	560
31121339	58	102	560
31121340	64	89	457
31121341	76	89	457
31121342	64	89	560

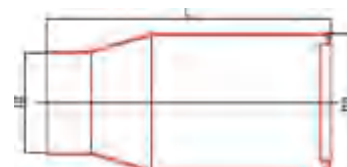

Part No.: P030-3

Round Tube ->ID<OD->Single Layer -> Rolled, Angle Cut

Order No.	Inlet Dia.	Outlet Dia.	Overall Length
31121401	58	76	305
31121402	58	89	305
31121403	58	102	305
31121404	58	76	457
31121405	58	89	457
31121406	58	102	457
31121407	58	76	560
31121408	58	89	560
31121409	58	102	560
31121410	64	76	457
31121411	64	89	457
31121412	76	89	457
31121413	64	89	560
31121414	76	89	560
31121415	64	89	305
31121416	89	102	305
31121419	57	70	163
31121430	102	127	158

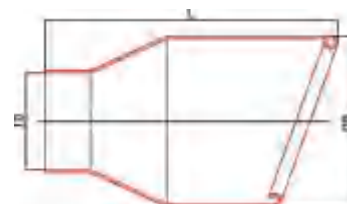

Part No.: P031

Round Tube -> ID<OD -> Single Layer -> Rolled, Angle Cut

Order No.	Inlet Dia.	Outlet Dia.	Overall Length
31121422	102	127	305
31121425	102	152	457
31121428	102	127	356
31121429	127	152	356
31121432	102	127	335
31121433	127	152	305
31121438	127	152	355.6



Part No.: P031-2

304 Polished Stainless Steel

Round Tube -> ID<OD -> Single Layer -> Rolled, Angle Cut

Order No.	Inlet Dia.	Outlet Dia.	Overall Length
31121442	64	76	178
31121443	64	89	457



Part No.: P031-3

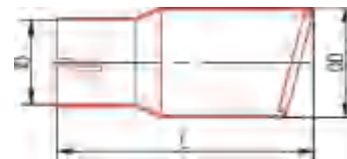

Round Tube -> ID<OD -> Double Layer -> Rolled, Angle Cut

Order No.	Inlet Dia.	Outlet Dia.	Overall Length
31122402	77	102	356



Part No.: P040



Round Tube -> ID<OD -> Single Layer -> DTM

Order No.	Inlet Dia.	Outlet Dia.	Overall Length
31121511	58	64	215



Part No.: P032-2

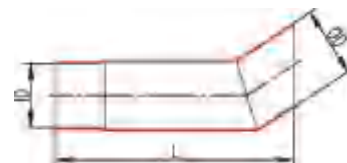

Round Tube -> ID<OD -> Single Layer -> Reverse Rolled, Straight Cut

Order No.	Inlet Dia.	Outlet Dia.	Overall Length
31121901	46	58	96
31121902	42	54	100
31121903	51	64	96
31121904	46	58	170
31121905	48	60	130



Part No.: P036

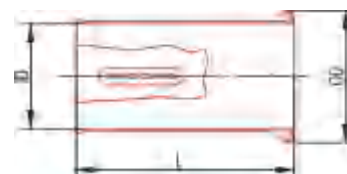

Round Tube -> ID<OD -> Single Layer -> Reverse Rolled, Straight Cut

Order No.	Inlet Dia.	Outlet Dia.	Overall Length
31121921	63	70	80



Part No.: P036-2

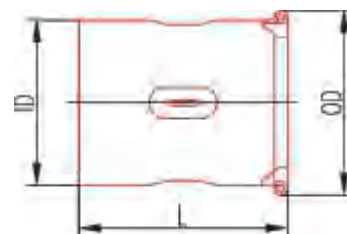

304 Polished Stainless Steel

Round Tube -> ID<OD -> Double Layer -> Rolled, Straight Cut

Order No.	Inlet Dia.	Outlet Dia.	Overall Length
31122301	51	76	178
31122302	58	114	254
31122303	58	127	254



Part No.: P039

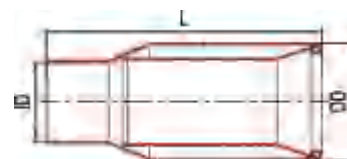

Round Tube -> ID<OD -> Double Layer -> Rolled, Straight Cut

Order No.	Inlet Dia.	Outlet Dia.	Overall Length
31122311	51	76	178



Part No.: P039-2

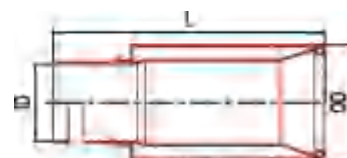

Round Tube -> ID<OD -> Double Layer -> Welded Bevel End, Inside Polished, Angle Cut

Order No.	Inlet Dia.	Outlet Dia.	Overall Length
31122881	64	89	138



Part No.: P044-5

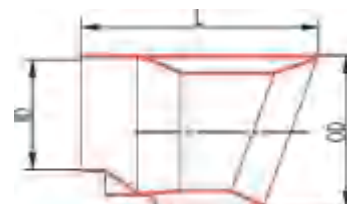

Round Tube -> ID<OD -> Double Layer -> Rolled, Angle Cut

Order No.	Inlet Dia.	Outlet Dia.	Overall Length
31122401	58	80	118



Part No.: P040-2

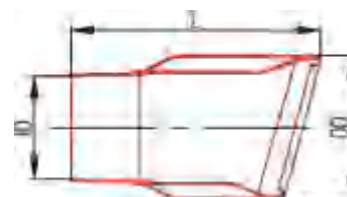

Round Tube -> ID<OD -> Double Layer -> Welded Bevel End, Inside Polished, Straight Cut

Order No.	Inlet Dia.	Outlet Dia.	Overall Length
31122702	58	76	178
31122703	58	89	178
31122704	58	102	114
31122705	64	89	114
31122706	58	102	178
31122707	102	127	305
31122708	64	89	178
31122721	34	89	145



Part No.: P043

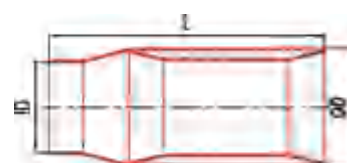

304 Polished Stainless Steel

Round Tube -> ID<OD -> Double Layer -> Welded Bevel End, Inside Polished, Straight Cut

Order No.	Inlet Dia.	Outlet Dia.	Overall Length
31122761	45	63	—
31122762	60	70	—



Part No.: P043-3

Round Tube -> ID<OD -> Double Layer -> Welded Bevel End, Inside Polished, Angle Cut

Order No.	Inlet Dia.	Outlet Dia.	Overall Length
31122801	58	102	178
31122802	58	102	114
31122804	89	102	457
31122805	102	127	305
31122806	58	105	102
31122808	58	89	406
31122809	64	89	140
31122810	58	76	106
31122824	76	89	165
31122825	60	89	134
31122826	51	76	130
31122827	77	102	178
31122829	68	102	178

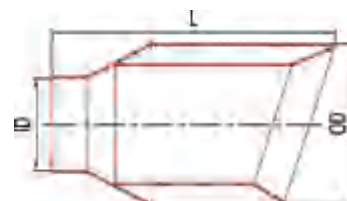

Part No.: P044

Round Tube -> ID<OD -> Double Layer -> Welded Bevel End, Inside Polished, Angle Cut

Order No.	Inlet Dia.	Outlet Dia.	Overall Length
31122811	58	102	197
31122812	64	102	197
31122813	64	114	190

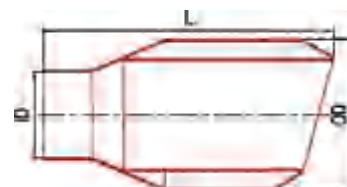

Part No.: P044-2

Round Tube -> ID<OD -> Double Layer, Silenced -> Rolled, Straight Cut

Order No.	Inlet Dia.	Outlet Dia.	Overall Length
31123317	33	38	258



Part No.: P048-4

Round Tube -> ID<OD -> Double Layer -> Welded Bevel End, Inside Polished, Angle Cut

Order No.	Inlet Dia.	Outlet Dia.	Overall Length
31122895	127	152	305

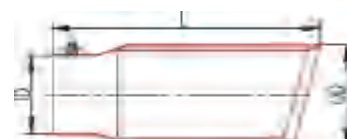

Part No.: P044-7

304 Polished Stainless Steel

Round Tube -> ID<OD -> Double Layer -> Welded Bevel End, Inside Polished, Angle Cut

Order No.	Inlet Dia.	Outlet Dia.	Overall Length
31122845	64	89	133
31122846	77	102	164
31122847	61	89	165

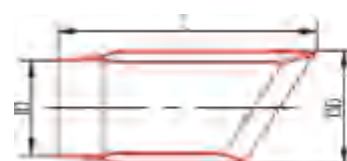

Part No.: P044-8

 Exhaust Tips
 (Round)

Round Tube -> ID<OD -> Double Layer, Silenced -> Rolled, Straight Cut

Order No.	Inlet Dia.	Outlet Dia.	Overall Length
31123303	82	102	220
31123304	83	102	229
31123305	86	102	228
31123306	58	102	220
31123307	70	89	203
31123308	64	89	203
31123310	52	89	205
31123311	82	100	305
31123313	58	89	205
31123316	45	64	210
31123338	70	127	178



Part No.: P048



Round Tube -> ID<OD -> Double Layer, Silenced -> Rolled, Straight Cut

Order No.	Inlet Dia.	Outlet Dia.	Overall Length
31123322	51	102	178
31123323	58	102	178
31123324	70	102	178
31123325	70	89	178



Part No.: P048-2

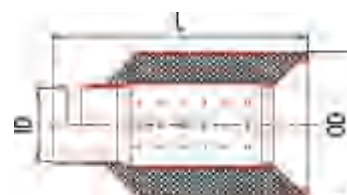

Round Tube -> ID<OD -> Double Layer, Silenced -> Rolled, Straight Cut

Order No.	Inlet Dia.	Outlet Dia.	Overall Length
31123353	72	89	273



Part No.: P048-3

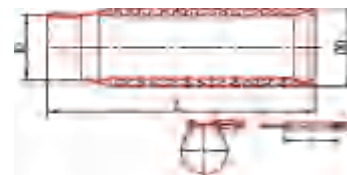

Round Tube -> Tapered Inlet -> Single Layer -> Rolled, Straight Cut

Order No.	Inlet Dia.	Outlet Dia.	Overall Length
31131301	80	89	330
31131302	90	100	330



Part No.: P057

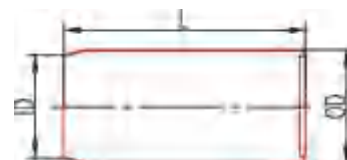

304 Polished Stainless Steel

Round Tube -> ID<OD -> Double Layer, Silenced -> Rolled, Angle Cut

Order No.	Inlet Dia.	Outlet Dia.	Overall Length
31123401	70	89	216
31123402	52	89	215
31123403	58	89	215
31123404	52	76	130
31123406	64	102	211
31123409	58	102	178

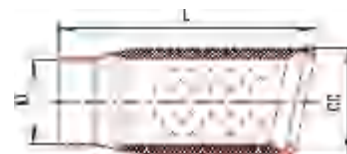

Round Tube -> ID<OD -> Double Layer, Silenced -> Welded Bevel End, Inside Polished, Angle Cut

Order No.	Inlet Dia.	Outlet Dia.	Overall Length
31123801	54	76	114
31123802	70	114	178
31123803	70	127	178
31123804	51	89	178

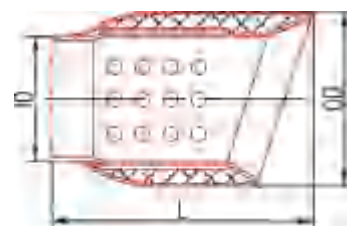

Round Tube -> Tapered Inlet -> Single Layer -> Straight Cut

Order No.	Inlet Dia.	Outlet Dia.	Overall Length
31131103	51	64	165
31131104	58	64	165

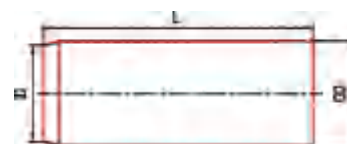

Round Tube -> Tapered Inlet -> Single Layer -> Angle Cut

Order No.	Inlet Dia.	Outlet Dia.	Overall Length
31131201	51	63	165
31131202	64	76	165
31131203	76	89	305



Round Tube -> Tapered Inlet -> Double Layer, Silenced -> Rolled, Straight Cut

Order No.	Inlet Dia.	Outlet Dia.	Overall Length
31133301	80	89	330
31133302	89	102	330



304 Polished Stainless Steel

Oval -> ID=OD -> Single Layer -> Rolled, Angle Cut

Order No.	Inlet Dia.	Outlet Dia.	Overall Length
31211411	135x75	135x75	330
31211414	135x75	135x75	350
31211418	165x75	165x75	330



Part No.: P085-2

Oval -> ID=OD -> Single Layer -> Rolled, Angle Cut

Order No.	Inlet Dia.	Outlet Dia.	Overall Length
31211426	116x87	116x87	300



Part No.: P085-3

Oval -> ID=OD -> Single Layer -> Rolled, DTM

Order No.	Inlet Dia.	Outlet Dia.	Overall Length
31211608	135x75	135x75	150

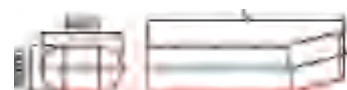

Part No.: P087

Oval -> ID=OD -> Double Layer -> Rolled, Straight Cut

Order No.	Inlet Dia.	Outlet Dia.	Overall Length
31212301	96x72	96x72	330



Part No.: P093

Oval -> ID=OD -> Double Layer -> Rolled, DTM

Order No.	Inlet Dia.	Outlet Dia.	Overall Length
31212601	120x90	120x90	330
31212602	152x102	152x102	310
31212603	152x102	152x102	330



Part No.: P096

304 Polished Stainless Steel

Oval -> ID=OD -> Double Layer -> Rolled, Angle Cut

Order No.	Inlet Dia.	Outlet Dia.	Overall Length
31212403	152x102	152x102	203
31212404	152x102	152x102	170



Part No.: P094



Oval -> ID=OD -> Double Layer -> Rolled, Angle Cut

Order No.	Inlet Dia.	Outlet Dia.	Overall Length
31212440	165x75	165x75	330



Part No.: P094-5



Oval -> ID=OD -> Double Layer -> Rolled, DTM

Order No.	Inlet Dia.	Outlet Dia.	Overall Length
31212630	135x75	135x75	200



Part No.: P096-3



Oval -> ID=OD -> Double Layer, Silenced -> Rolled, Angle Cut

Order No.	Inlet Dia.	Outlet Dia.	Overall Length
31213401	135x75	135x75	330
31213403	148x75	148x75	400



Part No.: P103



Oval -> ID=OD -> Double Layer, Silenced -> Rolled, Angle Cut

Order No.	Inlet Dia.	Outlet Dia.	Overall Length
31213421	152x102	152x102	330



Part No.: P103-3



304 Polished Stainless Steel

Oval -> ID=OD -> Double Layer, Silenced -> Rolled, DTM

Order No.	Inlet Dia.	Outlet Dia.	Overall Length
31213621	135x75	135x75	330



Part No.: P105-3

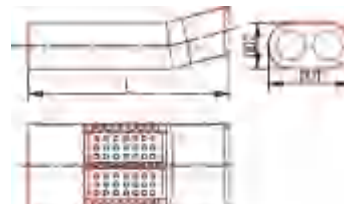

Oval -> ID<OD -> Single Layer -> Rolled, Angle Cut

Order No.	Inlet Dia.	Outlet Dia.	Overall Length
31221401	58	135x75	580
31221403	76	135x75	276



Part No.: P112



Oval -> ID<OD -> Single Layer -> Rolled, Angle Cut

Order No.	Inlet Dia.	Outlet Dia.	Overall Length
31221422	58	116x87	163



Part No.: P112-3



Oval -> ID<OD -> Single Layer -> Rolled, DTM

Order No.	Inlet Dia.	Outlet Dia.	Overall Length
31221602	58	135x75	254



Part No.: P114



Oval -> ID<OD -> Double Layer -> Angle Cut

Order No.	Inlet Dia.	Outlet Dia.	Overall Length
31222201	52	88x66	315



Part No.: P119



304 Polished Stainless Steel

Oval -> ID<OD -> Double Layer -> Rolled, Straight Cut

Order No.	Inlet Dia.	Outlet Dia.	Overall Length
31222303	46x57	84x70	148



Part No.: P120



Oval -> ID<OD -> Double Layer -> Rolled, Angle Cut

Order No.	Inlet Dia.	Outlet Dia.	Overall Length
31222401	58	116x87	178
31222404	64	116x84	167
31222407	52	96x70	210
31222409	76	116x86	178
31222412	52	121x76	127



Part No.: P121



Oval -> ID<OD -> Double Layer -> Rolled, Angle Cut

Order No.	Inlet Dia.	Outlet Dia.	Overall Length
31222471	58	135x75	480
31222472	58	135x75	184



Part No.: P121-6



Oval -> ID<OD -> Double Layer -> Rolled, Angle Cut

Order No.	Inlet Dia.	Outlet Dia.	Overall Length
31222486	58	135x75	200



Part No.: P121-7



Oval -> ID<OD -> Double Layer -> Rolled, Angle Cut

Order No.	Inlet Dia.	Outlet Dia.	Overall Length
31222490	58	135x75	200



Part No.: P121-8



304 Polished Stainless Steel

Oval -> ID<OD -> Double Layer -> DTM

Order No.	Inlet Dia.	Outlet Dia.	Overall Length
31222501	58	135x75	200



Part No.: P122



Oval -> ID<OD -> Double Layer -> Rolled, DTM

Order No.	Inlet Dia.	Outlet Dia.	Overall Length
31222621	56	84x70	156
31222622	46	84x70	198
31222623	52	84x70	161



Part No.: P123-2



Oval -> ID<OD -> Double Layer -> Rolled, DTM

Order No.	Inlet Dia.	Outlet Dia.	Overall Length
31222632	58	135x75	241
31222633	64	135x75	350



Part No.: P123-3



Oval -> ID<OD -> Double Layer -> Rolled, DTM

Order No.	Inlet Dia.	Outlet Dia.	Overall Length
31222641	58	135x75	200



Part No.: P123-4



Oval -> ID<OD -> Double Layer -> Welded Bevel End, Inside Polished, Straight Cut

Order No.	Inlet Dia.	Outlet Dia.	Overall Length
31222721	45	100x54	182



Part No.: P124-2



304 Polished Stainless Steel

Oval -> ID<OD -> Double Layer -> Welded Bevel End, Inside Polished, Angle Cut

Order No.	Inlet Dia.	Outlet Dia.	Overall Length
31222802	58	126x70	149



Part No.: P125



Oval -> ID<OD -> Double Layer -> Welded Bevel End, Inside Polished, Angle Cut

Order No.	Inlet Dia.	Outlet Dia.	Overall Length
31222821	55	114x87	187



Part No.: P125-2



Oval -> ID<OD -> Double Layer, Silenced -> Rolled, Straight Cut

Order No.	Inlet Dia.	Outlet Dia.	Overall Length
31223301	51	120x80	178
31223302	58	120x80	179
31223305	52	120x80	127



Part No.: P129

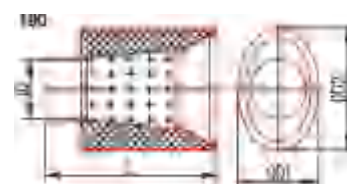

Oval -> ID<OD -> Double Layer, Silenced -> Rolled, Angle Cut

Order No.	Inlet Dia.	Outlet Dia.	Overall Length
31223402	64	152x102	254



Part No.: P130



Oval -> ID<OD -> Double Layer, Silenced -> Rolled, Angle Cut

Order No.	Inlet Dia.	Outlet Dia.	Overall Length
31223431	67	116x84	167
31223434	67	116x84	167
31223435	56	116x84	167
31223436	66	116x84	343
31223437	55	116x84	309



Part No.: P130-4



304 Polished Stainless Steel

Oval -> ID<OD -> Double Layer, Silenced -> Rolled, Angle Cut

Order No.	Inlet Dia.	Outlet Dia.	Overall Length
31223447	58	157x92	250



Part No.: P130-6

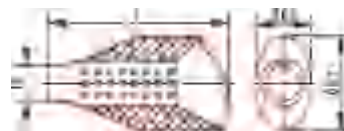

Oval -> ID<OD -> Double Layer, Silenced -> Rolled, DTM

Order No.	Inlet Dia.	Outlet Dia.	Overall Length
31223621	152x102	152x102	200



Part No.: P132-3



Oval -> ID<OD -> Double Layer, Silenced -> Rolled, DTM

Order No.	Inlet Dia.	Outlet Dia.	Overall Length
31223631	52	120x80	120+80
31223633	55	120x80	100+112
31223634	50	116x84	67+112
31223635	56	116x84	80+112
31223636	54	120x80	55+112



Part No.: P132-4



Oval -> Tapered Inlet -> Single Layer -> Angle Cut

Order No.	Inlet Dia.	Outlet Dia.	Overall Length
31231202	58	100x85	140



Part No.: P137



304 Polished Stainless Steel

Square -> ID \neq OD -> Single Layer -> Rolled, Straight Cut

Order No.	Inlet Dia.	Outlet Dia.	Overall Length
31321301	58	200x50	254

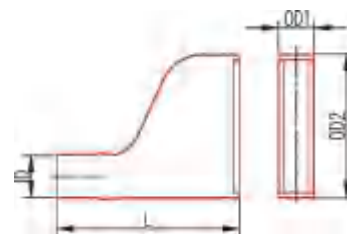

Part No.: P192

Square -> ID \neq OD -> Double Layer -> Rolled, Straight Cut

Order No.	Inlet Dia.	Outlet Dia.	Overall Length
31322301	61	98x89	208
31322302	58	98x89	208

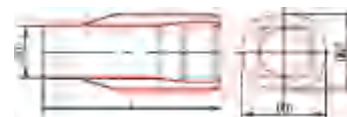

Part No.: P201

Square -> ID \neq OD -> Double Layer -> Weled Bevel End, Inside Polished, Straight Cut

Order No.	Inlet Dia.	Outlet Dia.	Overall Length
31322701	58	96x80	182



Part No.: P205

Square -> ID \neq OD -> Double Layer -> Weled Bevel End, Inside Polished, Angle Cut

Order No.	Inlet Dia.	Outlet Dia.	Overall Length
31322801	58	96x80	180



Part No.: P206

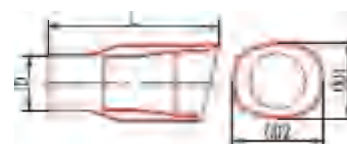

304 Polished Stainless Steel

Homocentric Outlet -> ID ≠ OD -> Double Layer -> Angle Cut

Order No.	Inlet Dia.	Outlet Dia.	Overall Length
31422201	64	102	210
31422202	51	94	210
31422203	58	102	210



Part No.: P281

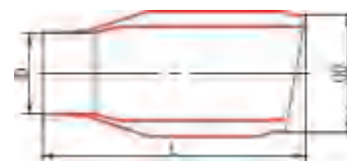

Exhaust Tips
(Homocentric)

Homocentric Outlet -> ID ≠ OD -> Double Layer -> Rolled, Straight Cut

Order No.	Inlet Dia.	Outlet Dia.	Overall Length
31422301	54	76	165
31422302	58	76	165



Part No.: P282

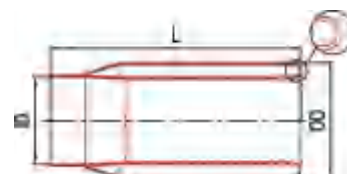

Homocentric Outlet -> ID ≠ OD -> Double Layer -> Rolled, Straight Cut

Order No.	Inlet Dia.	Outlet Dia.	Overall Length
31422331	52	76	190



Part No.: P282-3

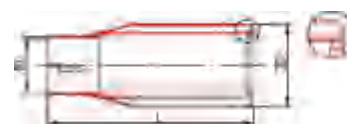

304 Polished Stainless Steel

Dual Outlet -> ID \neq OD -> Single Layer -> Straight Cut

Order No.	Inlet Dia.	Outlet Dia.	Overall Length
31521104	58	2x70	200

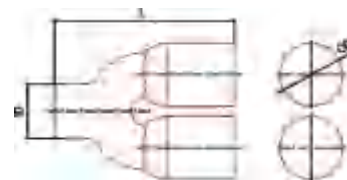

Part No.: P352

Dual Outlet -> ID \neq OD -> Single Layer -> Straight Cut

Order No.	Inlet Dia.	Outlet Dia.	Overall Length
31521111	64	2x70	120



Part No.: P352-2



Dual Outlet -> ID \neq OD -> Single Layer -> Straight Cut

Order No.	Inlet Dia.	Outlet Dia.	Overall Length
31521121	64	2x64	76
31882124	76	2x64	76



Part No.: P352-3

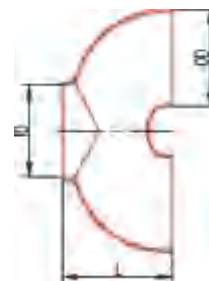

Dual Outlet -> ID \neq OD -> Single Layer -> Angle Cut

Order No.	Inlet Dia.	Outlet Dia.	Overall Length
31521201	64	64	254



Part No.: P353



Dual Outlet -> ID \neq OD -> Single Layer -> Rolled, Straight Cut

Order No.	Inlet Dia.	Outlet Dia.	Overall Length
31521203	64	57	322



Part No.: P353

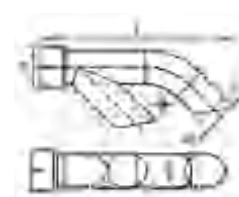

304 Polished Stainless Steel

Dual Outlet -> ID≠OD -> Single Layer -> Rolled, Straight Cut

Order No.	Inlet Dia.	Outlet Dia.	Overall Length
31521301	58	2x89	305



Part No.: P354



Dual Outlet -> ID≠OD -> Single Layer -> DTM

Order No.	Inlet Dia.	Outlet Dia.	Overall Length
31521501	58	2x89	330



Part No.: P356

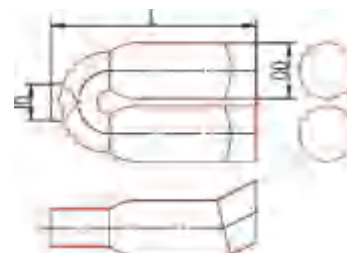

Dual Outlet -> ID≠OD -> Double Layer -> Rolled, Straight Cut

Order No.	Inlet Dia.	Outlet Dia.	Overall Length
31522302	58	2x76	254



Part No.: P363

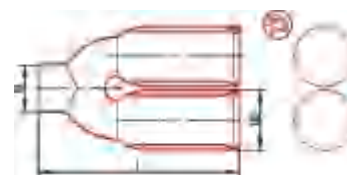

Dual Outlet -> ID≠OD -> Double Layer -> Rolled, Angle Cut, Square

Order No.	Inlet Dia.	Outlet Dia.	Overall Length
31522401	58	2x80x70	230



Part No.: P364

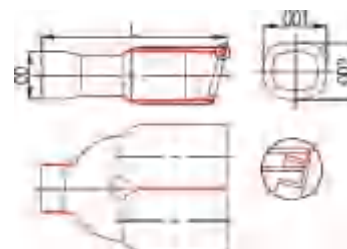

Dual Outlet -> ID≠OD -> Double Layer -> Rolled, Angle Cut

Order No.	Inlet Dia.	Outlet Dia.	Overall Length
31522402	64	2x89	191
31522411	58	2x76	254



Part No.: P364-2

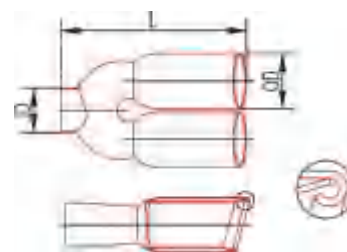

304 Polished Stainless Steel

Dual Outlet -> ID ≠ OD -> Double Layer -> Rolled, Angle Cut

Order No.	Inlet Dia.	Outlet Dia.	Overall Length
31522441	58	2x92x80	310
31522442	58	2x92x80	200



Part No.: P364-7



Dual Outlet -> ID ≠ OD -> Double Layer -> Weled Bevel End, Inside Polished, Straight Cut

Order No.	Inlet Dia.	Outlet Dia.	Overall Length
31522701	58	2x78x96	254
31522702	58	2x80x96	254



Part No.: P367

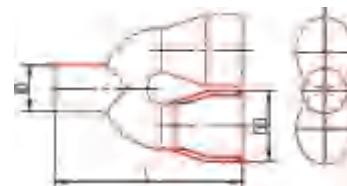

Dual Outlet -> ID ≠ OD -> Double Layer -> Welded Bevel End, Inside Polished, Angle Cut

Order No.	Inlet Dia.	Outlet Dia.	Overall Length
31522801	58	2x76	246/227
31522802	58	2x76	227/246



Part No.: P368

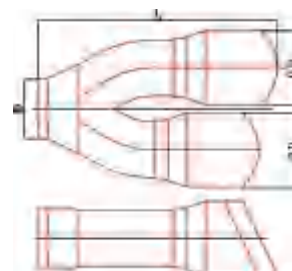

Dual Outlet -> ID ≠ OD -> Double Layer, Silenced -> Straight Cut

Order No.	Inlet Dia.	Outlet Dia.	Overall Length
31523101	58	2x70	330
31523103	58	2x70	200



Part No.: P370

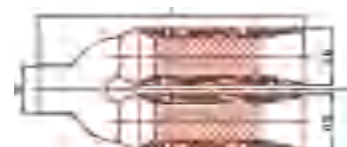

Dual Outlet -> ID ≠ OD -> Double Layer, Silenced -> Rolled, Straight Cut

Order No.	Inlet Dia.	Outlet Dia.	Overall Length
31523301	51	2x76	240
31523302	58	2x76	240
31523303	58	2x76	254
31523305	58	2x76	200
31523306	45	2x64	202
31523310	58	2x84	330
31523311	58	2x84	200



Part No.: P372

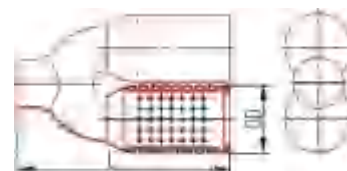

304 Polished Stainless Steel

Dual Outlet -> ID≠OD -> Double Layer, Silenced -> Rolled, Angle Cut

Order No.	Inlet Dia.	Outlet Dia.	Overall Length
31523421	58	2x76	200



Part No.: P373-2

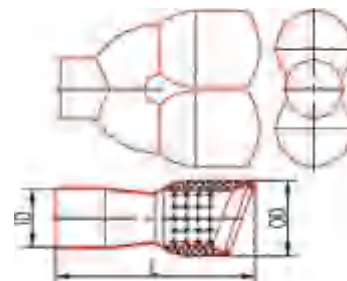

Dual Outlet -> ID≠OD -> Double Layer, Silenced -> Rolled, Angle Cut

Order No.	Inlet Dia.	Outlet Dia.	Overall Length
31523443	58	2x89	200/185



Part No.: P373-3

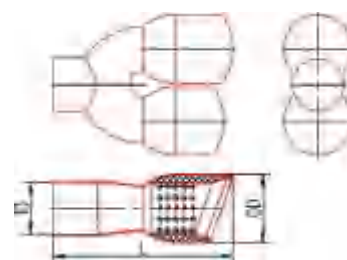

Dual Outlet -> ID≠OD -> Double Layer, Silenced -> DTM

Order No.	Inlet Dia.	Outlet Dia.	Overall Length
31523505	58	2x89	280



Part No.: P374

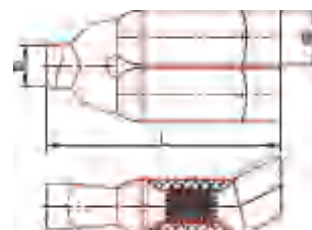

Dual Outlet -> ID≠OD -> Double Layer, Silenced -> Rolled, DTM

Order No.	Inlet Dia.	Outlet Dia.	Overall Length
31523601	58	2x76	230



Part No.: P375

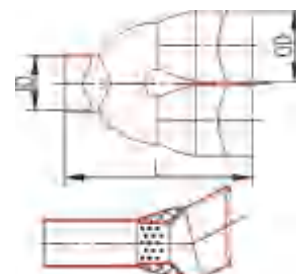

Dual Outlet -> ID≠OD -> Double Layer, Silenced -> Welded Bevel End, Inside Polished, Angle Cut

Order No.	Inlet Dia.	Outlet Dia.	Overall Length
31523801	48	2x76	235
31523802	51	2x76	260
31523803	58	2x89	260
31523805	51	2x76	205



Part No.: P377

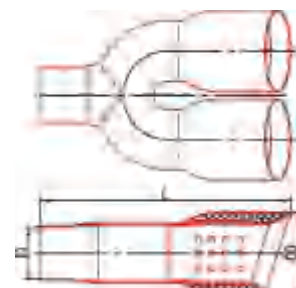

304 Polished Stainless Steel

Special Shape -> ID=OD -> Single Layer -> Straight Cut

Order No.	Inlet Dia.	Outlet Dia.	Overall Length
31611101	70	70	187



Part No.: P406

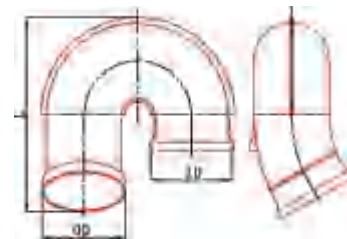

Special Shape -> ID=OD -> Single Layer -> "S" Tube

Order No.	Inlet Dia.	Outlet Dia.	Overall Length
31611201	76	76	370
31611202	63	63	330



Part No.: P407

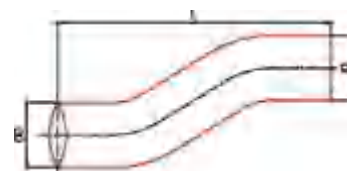

Special Shape -> ID=OD -> Single Layer -> Bended DTM

Order No.	Inlet Dia.	Outlet Dia.	Overall Length
31611502	76	76	330
31611503	76	76	301
31611504	76	76	340



Part No.: P410



Special Shape -> ID=OD -> Double Layer, Silenced -> Bended DTM

Order No.	Inlet Dia.	Outlet Dia.	Overall Length
31613502	76	76	400



Part No.: P428



Special Shape -> ID≠OD -> Single Layer -> Angle Cut

Order No.	Inlet Dia.	Outlet Dia.	Overall Length
31621201	2x36	76	742



Part No.: P434

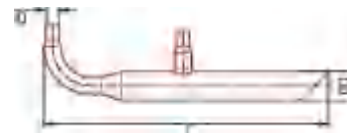

304 Polished Stainless Steel

Special Shape -> ID<OD -> Single Layer -> Turn Down

Order No.	Inlet Dia.	Outlet Dia.	Overall Length
31621502	89	102	305
31621503	64	76	330

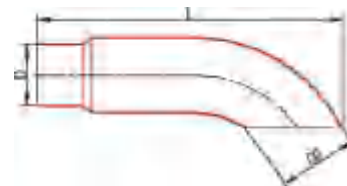

Part No.: P437

Special Shape -> ID>OD -> Single Layer -> Turn Down

Order No.	Inlet Dia.	Outlet Dia.	Overall Length
31611561	102	102	305
31611563	64	64	229

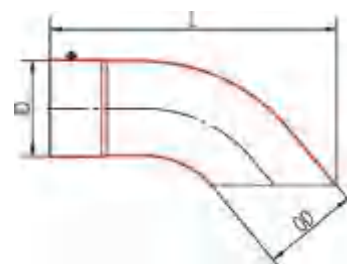

Part No.: P437-2

Special Shape -> ID≠OD -> Double Layer -> Rolled, Straight Cut, Turbo

Order No.	Inlet Dia.	Outlet Dia.	Overall Length
31622301	61	—	110
31622302	61	—	110
31622303	64	—	114

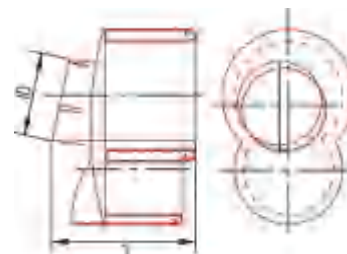

Part No.: P444

Special Shape -> ID<OD -> Double Layer -> Rolled, Angle Cut

Order No.	Inlet Dia.	Outlet Dia.	Overall Length
31622401	58	157x92	300

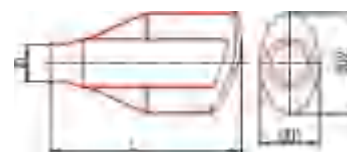

Part No.: P445

Special Shape -> ID<OD -> Double Layer, Silenced -> Rolled, Straight Cut

Order No.	Inlet Dia.	Outlet Dia.	Overall Length
31623301	36	51	250



Part No.: P453

Special Shape -> ID≠OD -> Single Layer -> Straight Cut

Order No.	Inlet Dia.	Outlet Dia.	Overall Length
31631102	76	120x38	508
31631103	58	110x49	229
31631104	58	120x38	508

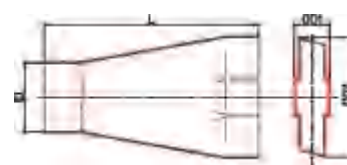

Part No.: P460

#304 Polished Stainless Steel Resonator

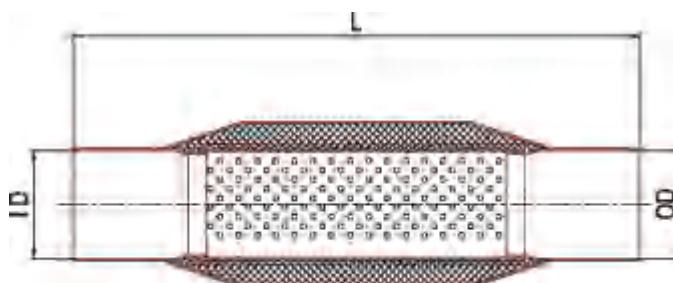
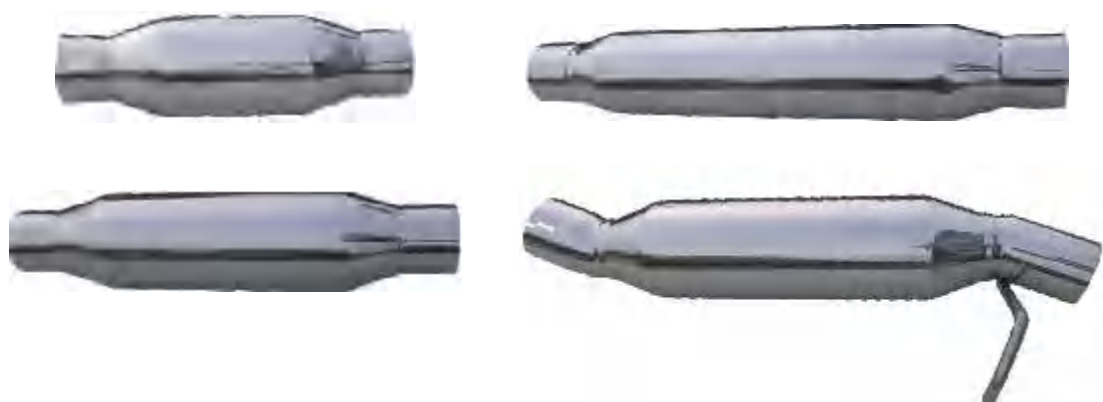

Order Number	Part Number	Inlet / Outlet Dia.	Overall Length
32101001	RS01	57	305
32101002		64	305
32101003		76	305
32101004		57	457
32101005		64	457
32101006		76	457
32101007		57	407
32101008		57	560
32101009		64	407
32101010		64	560
32101011		76	407
32101012		76	560
32101013		76	359
32101014		64	359
32101015		64	464
32101016		76	464
32101020		57	660
32101021		64	660
32101022		57	508
32101023		64	508
32101024		76	508
32101027		76	660

Flexible Tube



Without Inner Braid, Without Nipple

Order No.	ID(mm)	Overall Length(mm)
31902001	45	102
31902002	45	152
31902003	45	203
31902004	45	254
31902005	51	102
31902006	51	152
31902007	51	203
31902008	51	254
31902009	57	102
31902010	57	152
31902011	57	203
31902012	57	254
31902013	64	102
31902014	64	152
31902015	64	203
31902016	64	254
31902017	76	203
31902018	76	254

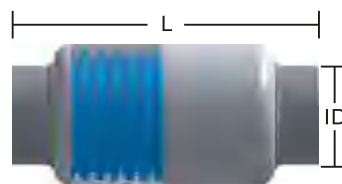

Part No.: FT-B

With Inner Braid, Without Nipple

Order No.	ID(mm)	Overall Length(mm)
31903001	45	102
31903002	45	152
31903003	45	203
31903004	45	254
31903005	51	102
31903006	51	152
31903007	51	203
31903008	51	254

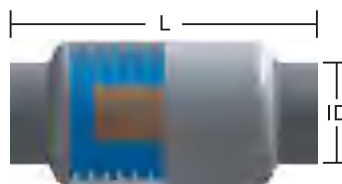

Part No.: FT-BIB

Flexible Tube

Without Inner Braid, With Nipple

Order No.	ID(mm)	Overall Length(mm)
31901001	45	203
31901002	45	254
31901003	45	305
31901004	45	355
31901005	51	203
31901006	51	254
31901007	51	305
31901008	51	355
31901009	57	203
31901010	57	254
31901011	57	305
31901012	57	355
31901013	64	203
31901014	64	254
31901015	64	305
31901016	64	355
31901017	76	254
31901018	76	305
31901019	76	355

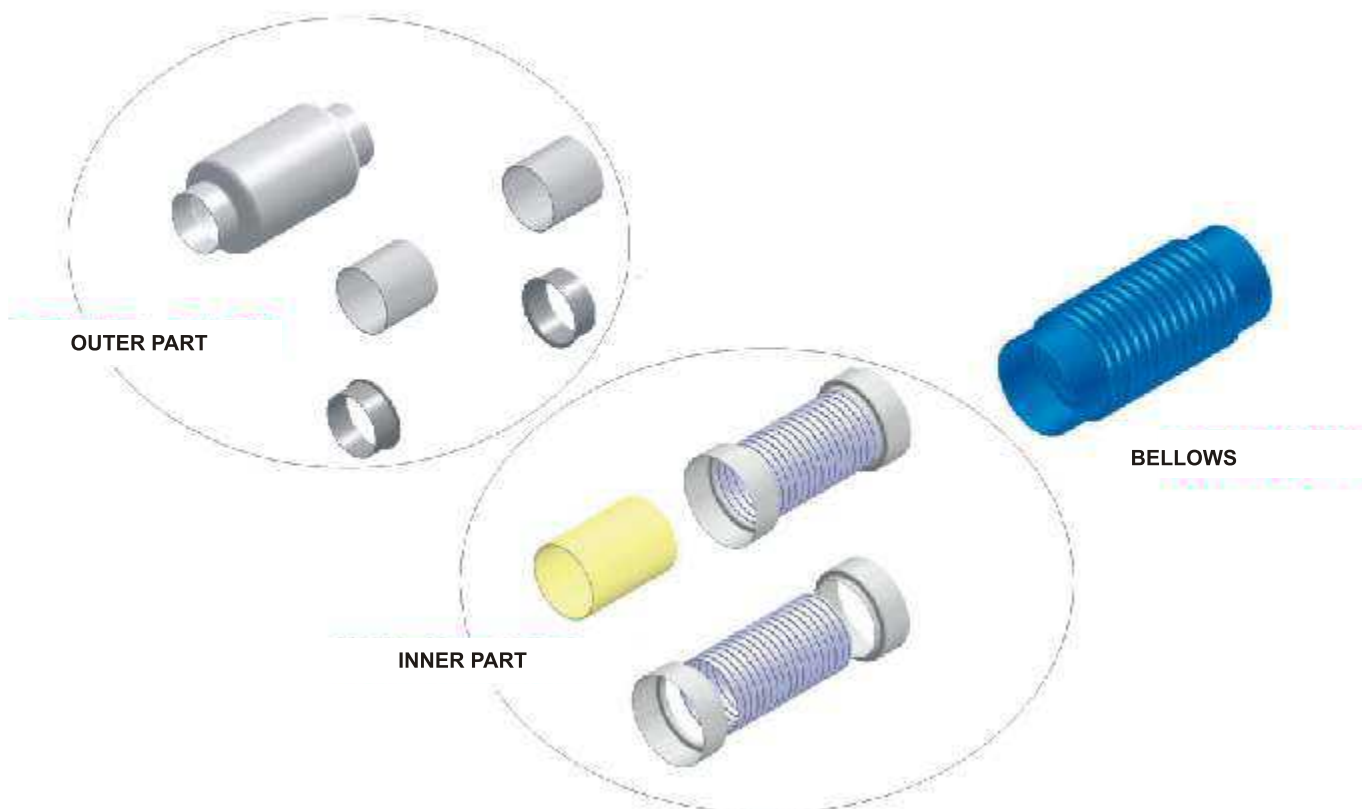

#304 Stainless Steel Universal Performance Mufflers



Oval Muffler ->One in One out -> Universal

Order number	Part Number	Dimensions (mm)			
		Inlet Dia.	Outlet Dia.	Silencer	Overall Length
31810001	MO01	58	58	203x127x355	508
31810002		64	64	198x128x346	508
31810003		76	76	198x128x346	508
31810004		51	51	198x128x346	508

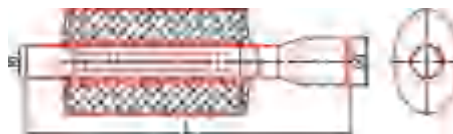

Oval Muffler ->One in One out -> Round Tip, Rolled

Order number	Part Number	Dimensions (mm)			
		Inlet Dia.	Outlet Dia.	Silencer	Overall Length
31811213	MO01-P030	58	89	203x127x355	622

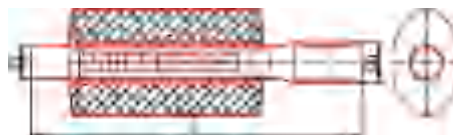

Oval Muffler ->One in One out -> Round Tip, Double Wall

Order number	Part Number	Dimensions (mm)			
		Inlet Dia.	Outlet Dia.	Silencer	Overall Length
31811227	MO01-P043	58	76	203x127x355	622

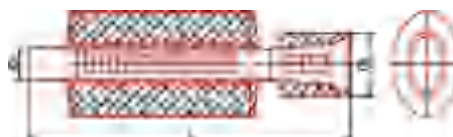

Oval Muffler ->One in One out -> Oval Tip, Silenced

Order number	Part Number	Dimensions (mm)			
		Inlet Dia.	Outlet Dia.	Silencer	Overall Length
31812233	MO01-P129	58	117x79	203x127x355	610

#304 Stainless Steel Universal Performance Mufflers



Oval Muffler ->One in One out -> Square Tip, Double Wall

Order number	Part Number	Dimensions (mm)			
		Inlet Dia.	Outlet Dia.	Silencer	Overall Length
31813224	MO01-P202	58	89X98	203x127x355	635

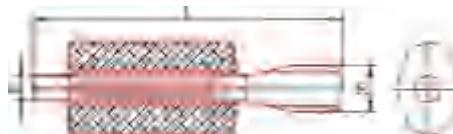

Oval Muffler ->One in One out -> Round Tip, Homocentric

Order number	Part Number	Dimensions (mm)			
		Inlet Dia.	Outlet Dia.	Silencer	Overall Length
31814222	MO01-P281	58	102	203x127x355	660



Oval Muffler ->One in Two out -> Universal

Order number	Part Number	Dimensions (mm)			
		Inlet Dia.	Outlet Dia.	Silencer	Overall Length
31830001	MO02	64	58	203x127x355	508
31830002		58	58	203x127x355	508

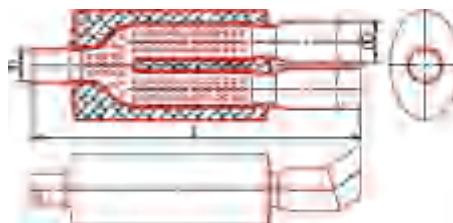

Oval Muffler ->One in Two out -> Dual Round Tip, DTM

Order number	Part Number	Dimensions (mm)			
		Inlet Dia.	Outlet Dia.	Silencer	Overall Length
31831215	MO02-P032	58	2x76	203x127x355	600
31831216		64	2x76	203x127x355	600

#304 Stainless Steel Universal Performance Mufflers

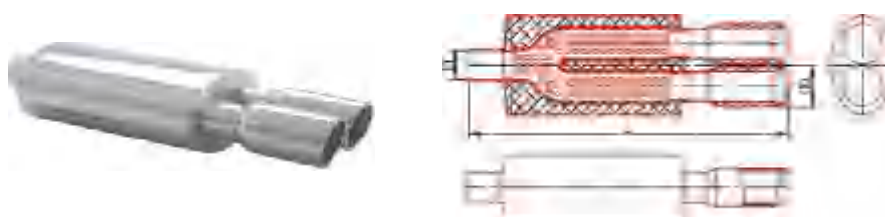

Oval Muffler ->One in Two out -> Dual Round Rolled Tip, Silenced

Order number	Part Number	Dimensions (mm)			
		Inlet Dia.	Outlet Dia.	Silencer	Overall Length
31833403	MO02-P049	58	2x82.5	203x127x355	645

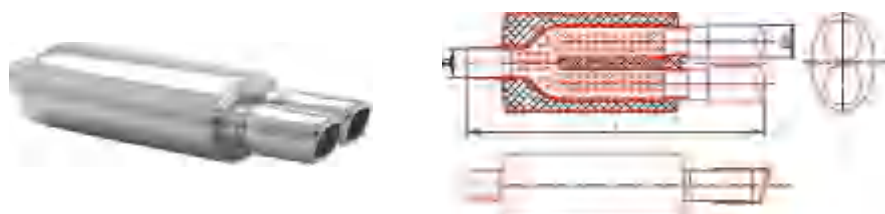

Oval Muffler ->One in Two out -> Dual Square Rolled Tip

Order number	Part Number	Dimensions (mm)			
		Inlet Dia.	Outlet Dia.	Silencer	Overall Length
31832403	MO02-P202	58	70x80	203x127x355	596

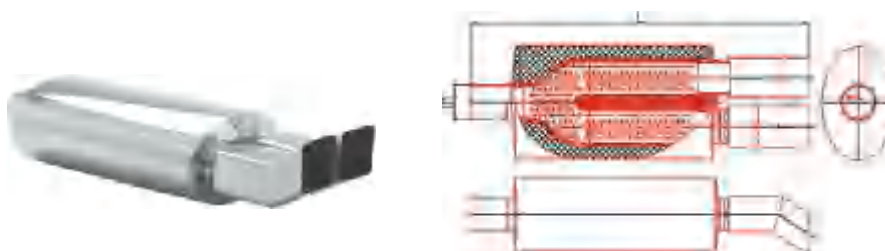

Oval Muffler ->One in Two out -> Dual Square Tip, DTM

Order number	Part Number	Dimensions (mm)			
		Inlet Dia.	Outlet Dia.	Silencer	Overall Length
31831521	MO02-P356-2	58	2x72x62	203x127x355	749

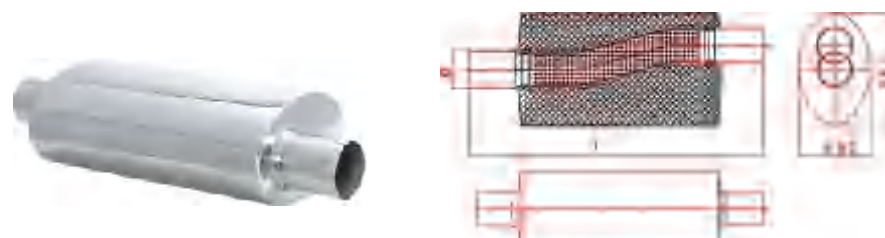

Oval Muffler ->Offset, One in One out -> Universal

Order number	Part Number	Dimensions (mm)			
		Inlet Dia.	Outlet Dia.	Silencer	Overall Length
31820001	MF01	64	64	128x198x346	523
31820002		76	76	128x198x347	523
31820004		84	84	198x128x346	523
31820005		76	76	198x128x346	523

#304 Stainless Steel Universal Performance Mufflers

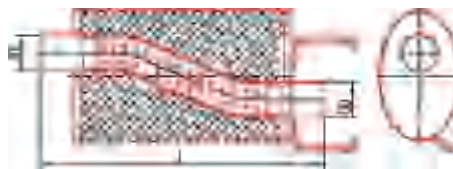

Oval Muffler ->Offset, One in One out -> Universal

Order number	Part Number	Dimensions (mm)			
		Inlet Dia.	Outlet Dia.	Silencer	Overall Length
31870001	MS01	64	64	240x149x381	521
31870002		64	64	240x149x381	521



Round Muffler ->One in One out -> Universal

Order number	Part Number	Dimensions (mm)			
		Inlet Dia.	Outlet Dia.	Silencer	Overall Length
31850001	MR01	58	102	Ø 152x368	580
31850002		58	102	Ø 152x368	693
31850003		58	57	Ø 102x305	406
31850007		64	64	Ø 152x396	508
31850008		77	77	Ø 152x396	508
31850009		64	64	Ø 127x326	326
31850015		76	76	Ø 152x368	489
31850016		58	102	Ø 152x368	580
31850017		58	102	Ø 152x298	580



Round Muffler ->One in One out -> Universal

Order number	Part Number	Dimensions (mm)			
		Inlet Dia.	Outlet Dia.	Silencer	Overall Length
31850011	MR01-2	58	114	Ø 152x368	658

#304 Stainless Steel Universal Performance Mufflers

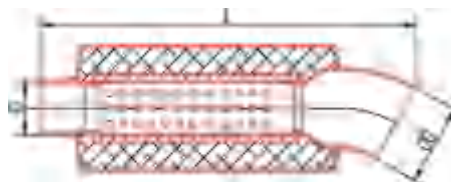

Oval Muffler -> One in One out -> Turn Down

Order number	Part Number	Dimensions (mm)			
		Inlet Dia.	Outlet Dia.	Silencer	Overall Length
31851000	MR01-3	64	102	Ø 152x320	450
31851001		76	102	Ø 150x320	450

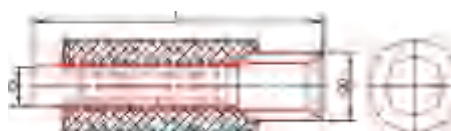

Round Muffler -> One in One out -> Round Rolled Tip, Double Wall

Order number	Part Number	Dimensions (mm)			
		Inlet Dia.	Outlet Dia.	Silencer	Overall Length
31852002	MR01-4	77	114	Ø 152x320	480

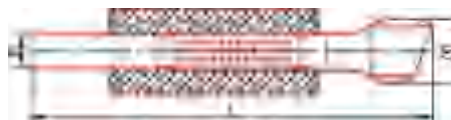

Round Muffler -> One in One out -> Round Tip, Double Wall

Order number	Part Number	Dimensions (mm)			
		Inlet Dia.	Outlet Dia.	Silencer	Overall Length
31851228	MR01-P044-2	58	114	Ø 152x368	710

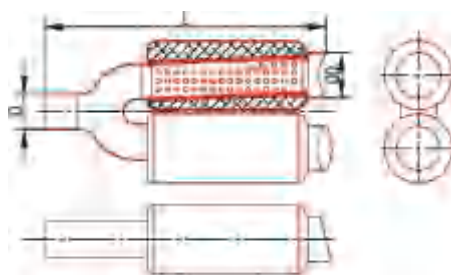

Round Muffler -> Dual Silencer -> Universal

Order number	Part Number	Dimensions (mm)			
		Inlet Dia.	Outlet Dia.	Silencer	Overall Length
31860001	MR02	64	2x76	2x Ø 152x368	630

#304 Stainless Steel Universal Performance Mufflers



Round Muffler ->One in One out -> Universal, Tuning

Order number	Part Number	Dimensions (mm)			
		Inlet Dia.	Outlet Dia.	Silencer	Overall Length
31850020	MR03-1	58	102	Ø 145x368	440
31850021		64	102	Ø 145x368	440



Round Muffler ->One in One out -> Universal, Tuning

Order number	Part Number	Dimensions (mm)			
		Inlet Dia.	Outlet Dia.	Silencer	Overall Length
31850031	MR03-2	64	114	Ø 152x320	480
31850033		64	114	Ø 152x320	430
31850034		77	114	Ø 152x320	480

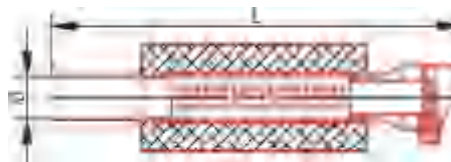

Round Muffler ->One in One out -> Universal, Tuning

Order number	Part Number	Dimensions (mm)			
		Inlet Dia.	Outlet Dia.	Silencer	Overall Length
31850051	MR03-3	77	114	Ø 152x320	570
31850052		64	114	Ø 152x320	475

CHRYSLER

Part No.	Order Number	Application
DFPT01	32030100	PT Cruiser 2.4L
DFCL02	32030300	(Dodge) Neon 94-99



DFPT01

Acura

Part No.	Order Number	Application
DFAR01	32010100	Integra LS/RS/GS 94-01
DFAR02	32010200	RSX Type S 2002-Up



DFAR01



DFAR02

FORD

Part No.	Order Number	Application
DFFD02	32040200	Focus ZX3 sedan 00-01



DFFD01, DFFD02

MITSUBISHI

Part No.	Order Number	Application
DFMT01	32100100	Eagle Talon 95-98 / Eclipse 95-99



DFHY01

MAZDA

Part No.	Order Number	Application
DFMD01	32130100	Miata 90-98
DFMD02	32130200	Miata 99 - Up
DFMD03	32130300	Protege 01 - Up



DFMD01, DFMD02

HONDA

Part No.	Order Number	Application
DFHD01	32020100	Civic Sedan/Coupe 92-00
DFHD02	32020200	Civic Hatchback 92-00



DFHD01, DFHD02, DFHD06



DFHD07



DFHD03, DFHD04



DFHD08

SUBARU

Part No.	Order Number	Application
DFSB01	32150100	WRX 01-03



DFSB01

TOYOTA

Part No.	Order Number	Application
DFTY01	32160100	Celica 00-02



DFTY01

VW

Part No.	Order Number	Application
DFVW01	32050100	New Beetle/Golf



DFVW01, DFVW02

Parts and Accessories

Clamp



Catalytic Converter



Hanging Belt



Perforated Tube



SS1: Φ 145mm SS2: 198x128mm
SS3: Φ 152mm

Adapter



Flange



Bent Tube



Display Rack Set



X-Pipe



Various Packaging Available

